

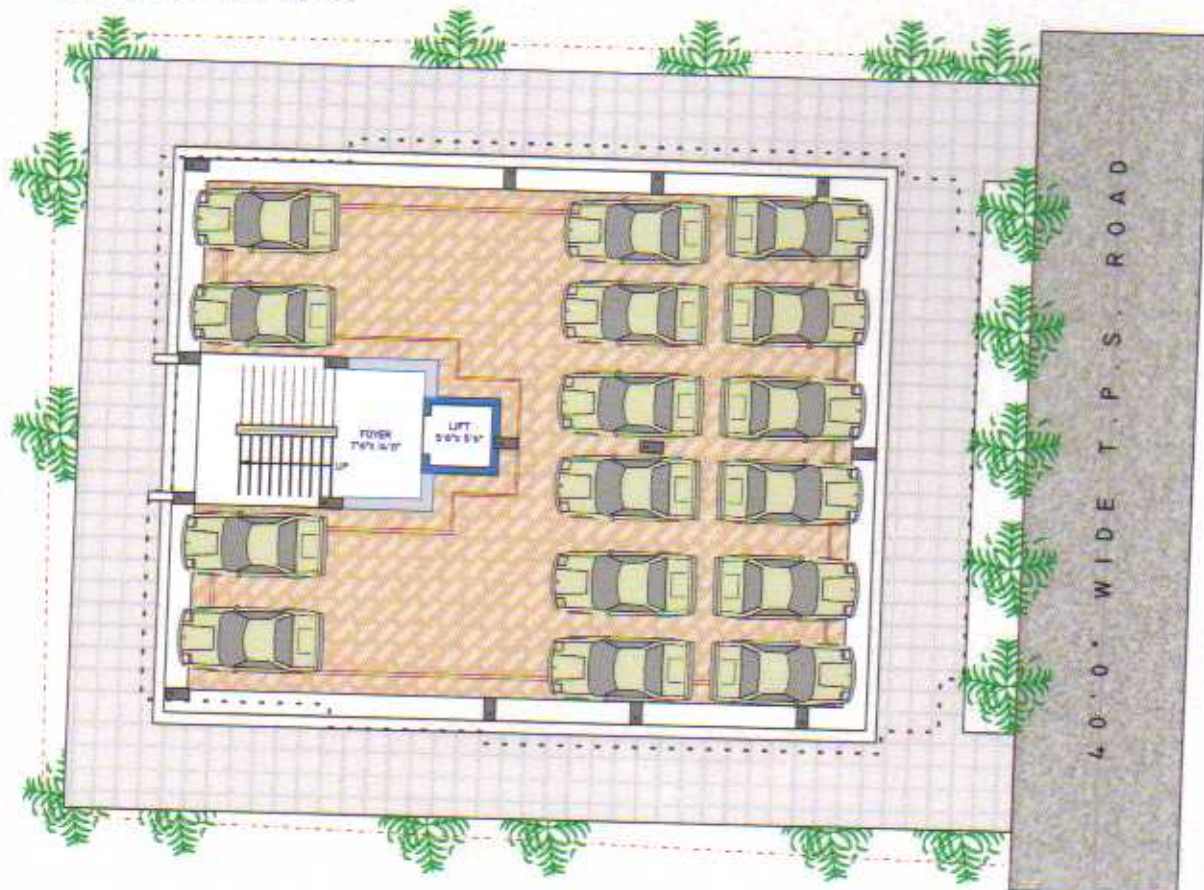

SITE FLOOR PLAN



SPECIFICATIONS

STRUCTURE

- Earthquake resistant design

PLASTER WORK

- Double coat sand faced plaster on external walls with texture finish/cladding.
- Single coat plaster on internal walls with white cement based putty work.

DOORS & WINDOWS

- Attractive main door made of waterproof plywood.
- Internal doors with wooden/granite frames & water proof flush doors.
- Standard quality fittings for all doors.
- Powder coated/Anodized colour windows Granite windows Sills.

PLUMBING & SANITATION

- Plumbing fitting (Jaquar or equivalent brand)
- Corrosion resistant and leak proof CPVC/UPVC Pipes & Fittings.
- Sanitary ware (Cera or Equivalent brand)

FLOORING

- 32" x 32" Vitrified Tiles flooring in living, Dining, Kitchen & Passages.
- High end 32" x 32" Vitrified tiles flooring in all other bedrooms.
- Vitrified/Glazed tiles flooring & dado in all bathrooms & kitchen up to lintel level.
- China mosaic flooring on terrace with waterproofing treatment.

ELECTRIC WORK

- Concealed Copper ISI brand wires. Adequate points with Modular Switches in all rooms with Circuit Breaker.

KITCHEN

- Granite Platform with Stainless Steel Sink.

WATER

- Water supply Through AMC line & Bore.

PAINTING

- Long Lasting acrylic Paint on all external wall with cladding/texture.
- All internal wall finished with putty finish.

ELEVATOR

- Branded V3F Elevator with 5 persons capacity.

LOBBY, PARKING & COMMON PASSAGES

- Kota Stone flooring in parking area.
- Decorative entrance foyer.

LEGAL NOTES : Stamp duty, Registration Charges, Legal Charges, Service Tax, AMC Charges & Ele. Co. Charges for cable and sub-station cost etc shall be borne by the purchaser. Any additional Charges or duties levied by the Government/local authorities during or after the completion of the project will borne by the purchaser. Charges/alternation of any nature including the elevation, Exterior colour scheme of the building or any other changes affecting the overall design concept and outlook of the project are strictly NOT PERMITTED during or after the completion of the project. Irregular payment shall cause cancellation of booking. At the time of cancellation of booking 10% Service Charge of the total amount pay shall be levied and balance payment shall be made only after the next available booking. Subject to Ahmedabad jurisdiction.

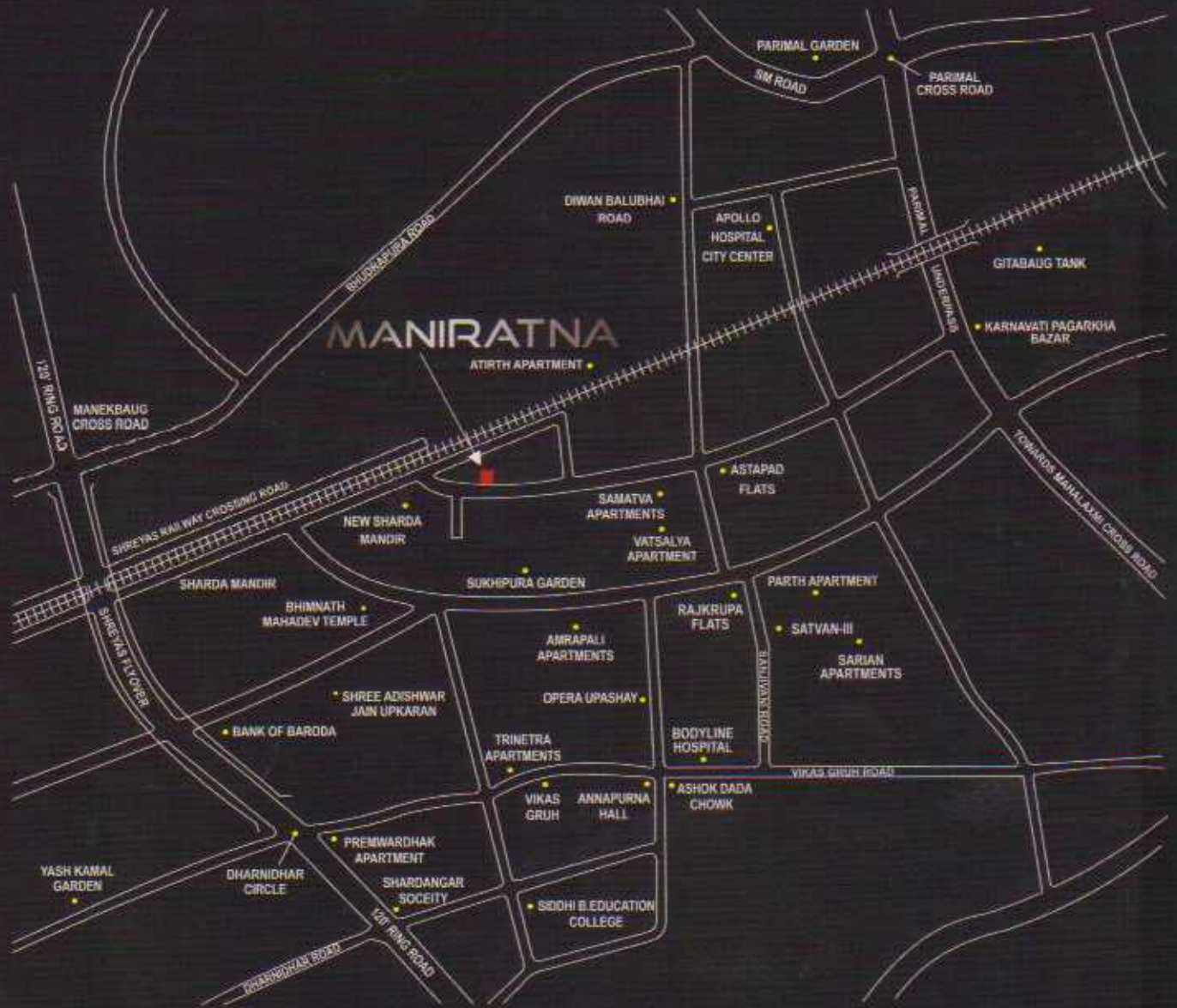

MAGNA INFRACON

— ORGANISER AND BUILDERS —

e-mail : magnainfracon@gmail.com

M.: 91.9979224487 / 9825019052